

BT-NG-020621-545-0016

Bramford to Twinstead Reinforcement

Volume 2: Plans and Drawings

Document 2.11.2 (B): Design and Layout Plans: Grid Supply
Point Substation Elevations

Final Issue B
October 2023

Planning Inspectorate reference: EN020002

Infrastructure Planning (Applications: Prescribed Forms and Procedure) Regulations 2009 Regulation 5(2)(o)

nationalgrid

Version History			
Date	Issue	Status	Description / Changes
April 2023	A	Final	For DCO submission
October 2023	B	Final	This document has been updated to include the location, extent and height of the proposed landscape mounding in response to question CM1.5.20 asked in ExQ1

Page intentionally blank



Reproduced from Ordnance Survey maps by permission of Ordnance Survey on behalf of the controller of His Majesty's Stationery Office. © Crown Copyright Ordnance Survey. Licence no. 0100059731

Notes

1. All dimensions are in millimetres unless noted otherwise.
2. All levels and chainages are in metres unless noted otherwise.
3. Underground services are not currently shown on this drawing but will be incorporated following the GPR survey.
4. The details in this drawing are indicative only. The final position and design will be within the parameters contained within the DCO with reference to the Work Plans.

Legend

- Existing Overhead line
 - Underground cable
 - Order limits
 - Ancient woodland
 - Proposed 400kV overhead line
 - Existing 400kV overhead line
 - Existing 400 kV overhead line
 - Existing 132 kV overhead line
- RB
4YL
4YLA
PCB

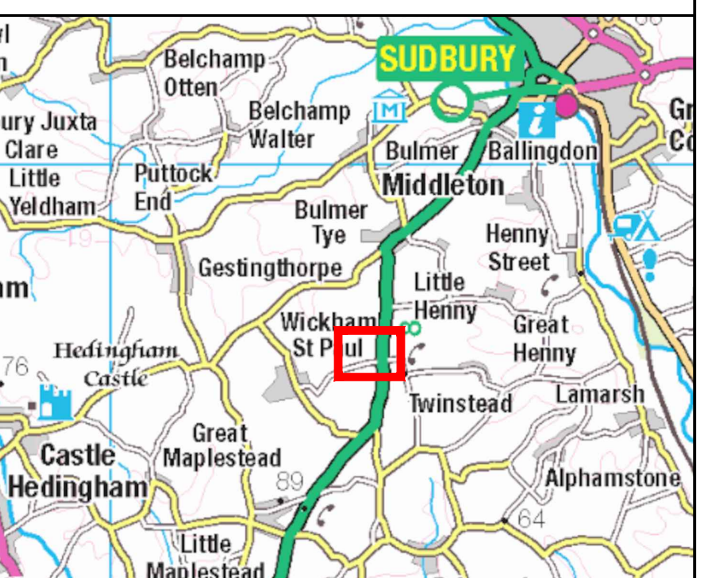

Reference should be made to Document 2.1 Guide to the Plans which provides further information on what the plans show.

NG Investment No. 21847

ISSUE	DATE	REMARKS	DRAWN	CHKD	APPD
B	24/10/23	Addition of landscape mounding for Reading 3	NP	DF	RF
A	17/02/23	Rev A for DCO application	NP	DF	RF

PROJECT	TITLE
Bramford to Twinstead Reinforcement	2.11.2(B) Design and Layout Plans: Grid Supply Point Substation Elevations

CIRCUIT / SITE	ACAD
Bramford - Pelham & Bramford - Braintree - Bulls Lodge	ACAD

ORIGINATOR DRAWING No.	A1
B31000F9-JAC-ZZ-XX-DR-E-0002	A1

NG DRAWING No.	Sheet No.	No. of Sheets	Issue
BT-NG-020621-545-0016	1	1	B
Scale:-	1:750 U.N.O		

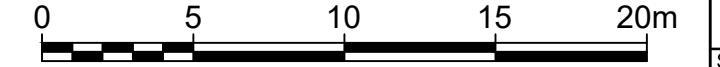
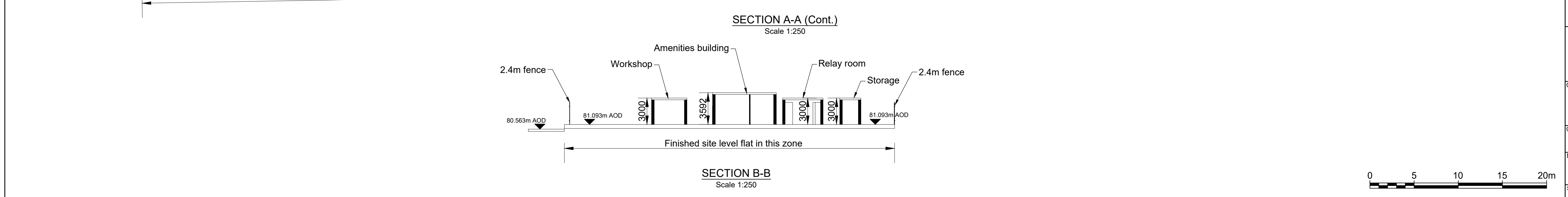
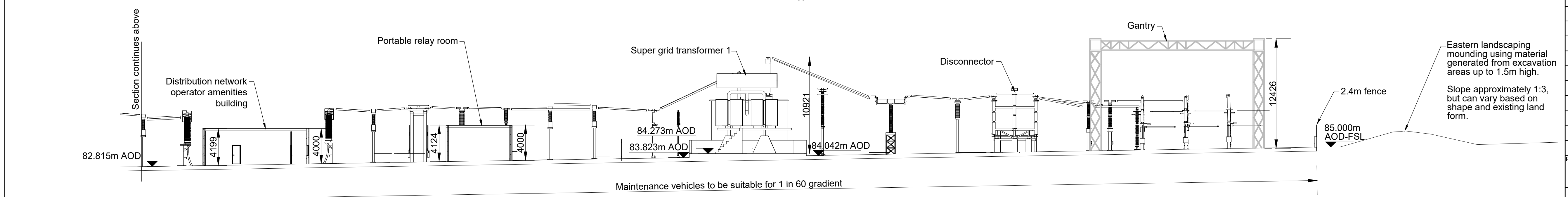
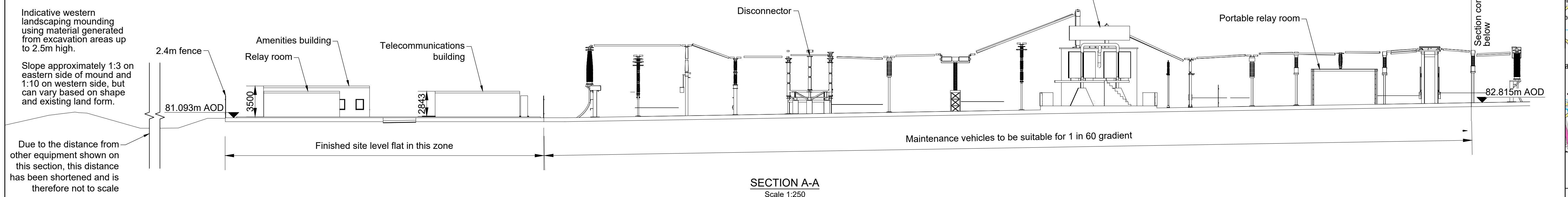
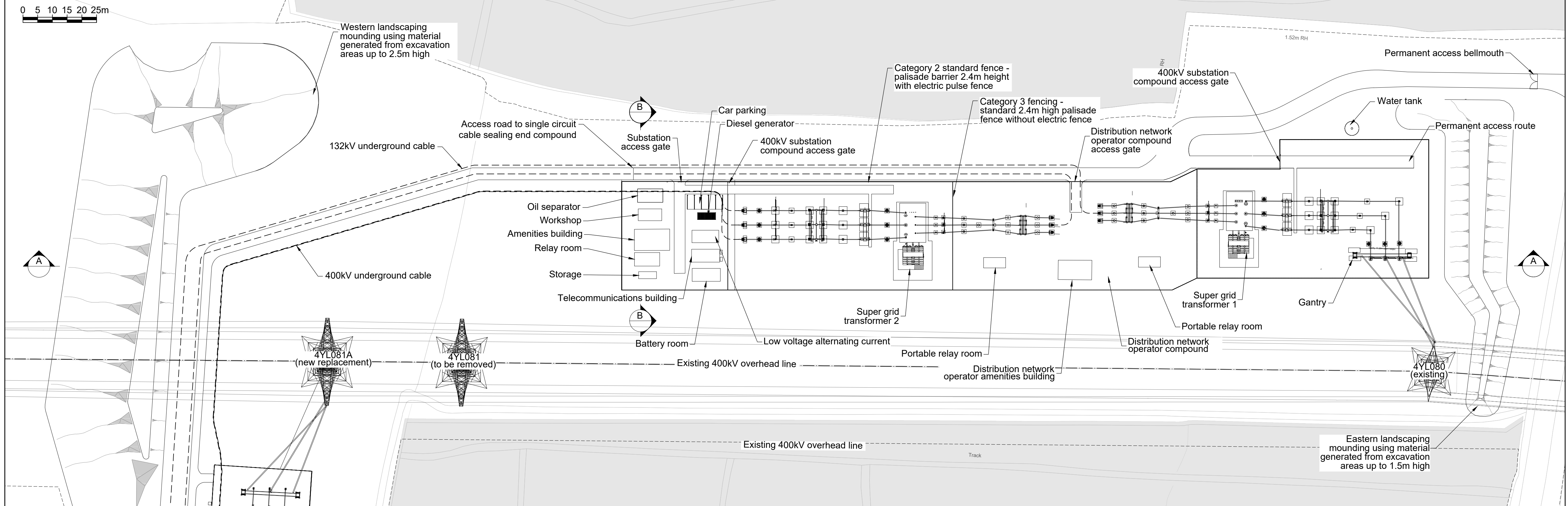

Page intentionally blank

National Grid plc
National Grid House,
Warwick Technology Park,
Gallows Hill, Warwick.
CV34 6DA United Kingdom

Registered in England and Wales
No. 4031152
nationalgrid.com